

PLEASE IDENTIFY THE PART IN THE  
DIAGRAM AND RE FAX ON 5774339

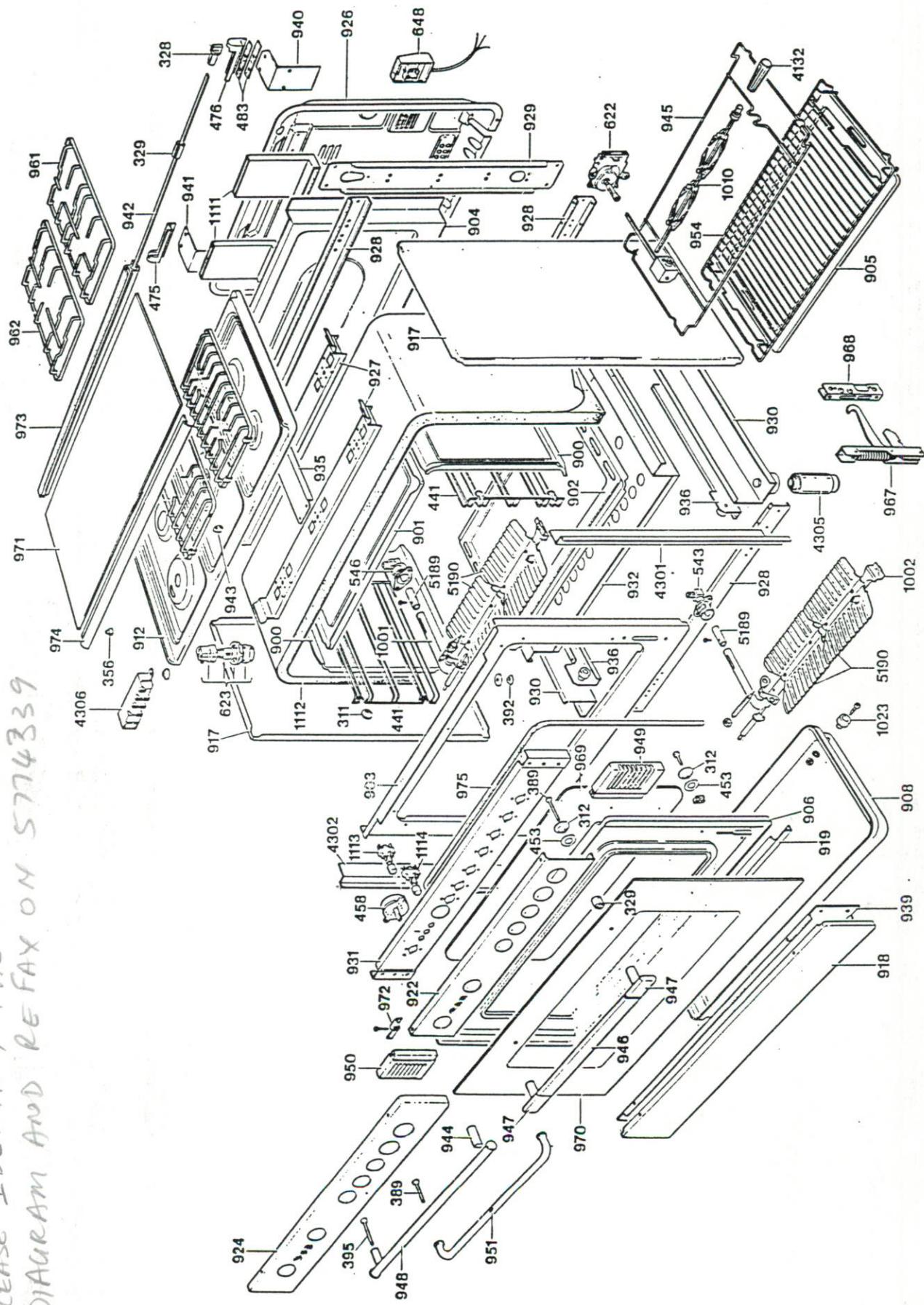

M-9060 WOK

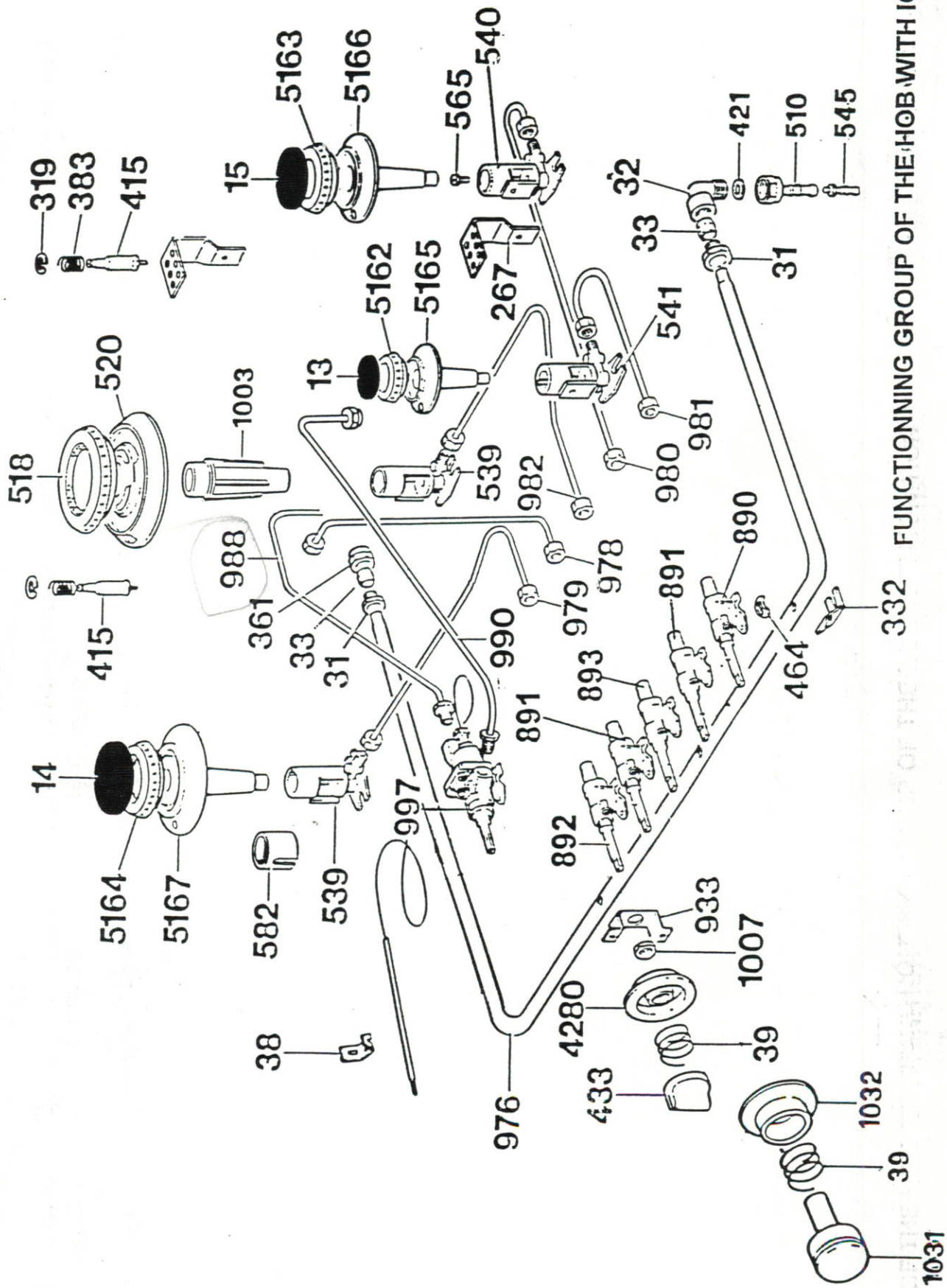

FUNCTIONING GROUP OF THE HOB WITH IGNITION

OF THE

\*\*\*DB101C \*\*\*

ARTICLO N° DISEGNO COMPONENTE	DESCRIZIONE ARTICOLI	UM	CONSUMO UNIT.
M9103RLZX.1N3 .....	M90601 WOK X GAS COOKER "PHILCO"	N.	
301005	SCREW M4 X 16 T.S.P. CR ZINC	N.	4,000
301005	SCREW M4 X 16 T.S.P. CR ZINC	N.	2,000
301017	SCREW 8PX13	N.	79,000
301019	SCREW 7X13 A.T.F. T.C. CR ZINC	N.	3,000
301024	SCREW 8P X 22	N.	6,000
301034	SCREW 8P X 16 TS M/6000	N.	6,000
301052	SCREW 4X14 CR FE DIN 7981	N.	10,000
301059	SCREW 4.8X10 ATF P.T. T.C. CR BR	N.	2,000
301060	SCREW 3.9X30 ATF T.S.C. CR NIC.	N.	2,000
301061	SCREW 3.9X9.5 ATF P.T. T.C. CR BR	N.	17,000
301076	SCREW M4X6 T1/2T TC ZN	N.	12,000
302025	NUT FOR PART FOR THERMOCOUPLE	N.	1,000
302032	NUT	N.	2,000
303003	RIVET M4	N.	4,000
303003	RIVET M4	N.	2,000
303010	RIVET	N.	6,000
303014	RIVET 2,9 X 7	N.	4,000
303021	RIVET 4,8 X 16	N.	2,000
304004	CLAMP FIXORAPID M/6000	N.	2,000
305010	WASHER SIAM 5	N.	2,000
305021	WASHER DIAM 10X5,2X1	N.	11,000
305024	WASHER 15 X 5 X 3	N.	4,000
305028	WASHER DIAM 10	N.	4,000
307007	TARGET OF TYPE OF GAS	N.	2,000
307085	ENVELOPE WITH NOZZLES	N.	1,000
307251	QUALITY CONTROL LABEL	N.	1,000
307290	INSTRUCTION BOOK	N.	1,000
307350	PRINT LABEL	N.	1,000
307355	LABEL ''PRODUCT QUALITY''	N.	1,000
307407	LABEL	N.	1,000
309011	IRON WIRE MM 1 M/6000	N.	2,000
309015	PART FOR THERMOCOUPLE	N.	1,000
402036	WHITE GLUE	N.	0,010
407005	POLYSTYRENE FOR BURNER	N.	5,000
407012	NYLON ENVELOPE	N.	1,000
407034	POLYSTYRENE	N.	1,000
407088	LABEL FOR PACKING	N.	1,000
407106	FRONT CORNER FOR PACKING	N.	2,000
407141	CARDBOARD BOX FOR PACKING	N.	1,000
407143	POLYSTYRENE FOR PACKING	N.	1,000
407146	STRAP FOR PACKING	MT	9,500
407149	BACK CORNER FOR PACKING	N.	2,000
407172	SPONGE STRIP FOR PACKING	N.	2,000
407178	WOOD BASE FOR PACKING	N.	1,000
50302901	GAS THERMOSTAT	N.	1,000
601224	WIRING 5 BURNERS GAS OVEN	N.	1,000
910134C	COOKER EQUIPMENT	N.	1,000
13 101099	ENAM.COVER FOR SMALL BURNER BLACK	N.	1,000
14 101101	ENAM.COVER FOR BIG BURNER BLACK	N.	1,000
15 101100	ENAM.COVER FOR MEDIUM BURNER BLACK	N.	2,000
31 302001	NIPPL0 1/2 GAS	N.	2,000

\*\*\*DB101C \*\*\*

ARTICOLO N° DISEGNO COMPONENTE	DESCRIZIONE ARTICOLI	UM	CONSUMO UNIT.
*****	*****	*****	*****
32 302002	PIPE FITTING ELBOW 1/2 GAS	N.	1,000
33 302003	DOUBLE CONE RING DIAM 14	N.	2,000
38 306003	THERMOSTAT CLIP	N.	2,000
39 306002	INOX SPRING FOR KNOB	N.	7,000
252 202005	KNOBS PROTECTION N/90	N.	1,000
267 201089	SPARK PLUG SUPPORT TERMOC	N.	4,000
311 309010	RING FOR GRID SUPPORT 6000	N.	4,000
312 199132	OVEN GLASS FIXING RING	N.	4,000
313 301063	SCREW	N.	2,000
319 304001	BENZING 5 DIN 6799	N.	4,000
322 302024	NUT 5MA	N.	6,000
323 305008	WASHER DIAM 5	N.	9,000
326 302018	NUT 4 MA	N.	2,000
328 309094	PIN FOR GLASS TOP COVER M9/D2	N.	2,000
329 309049	TORSION BAR CATCH P6-P9	N.	1,000
329 309097	INSIDE OVEN DOOR SPACER	N.	2,000
332 309046	BRIDLE FOR FIXING GAS VALVES M6	N.	6,000
338 302016	NUT FOR THERMOCOUPLE N/20	N.	12,000
345 305006	WASHER 7X14X1,2	N.	4,000
347 301032	SCREW 5MA X 15C	N.	4,000
352 305003	WASHER 22 X 10 X 2,5	N.	2,000
356 308007	DOWN BUMPER FOR CYLINDER SPACE DOOR	N.	2,000
361 302034	GAS COLLECTOR TAP	N.	1,000
363 303004	RIVET 4X8 ALLUM.	N.	2,000
364 301008	SCREW 5MA X 10 T 1/2 T	N.	35,000
374 301020	SCREW MAX7 TC CR ZINC	N.	1,000
383 306001	SPRING FOR SPARK PLUG P	N.	4,000
389 301077	SCREW M5X35 FOR HANDLE	N.	2,000
392 309026	PART FOR KNOB PROTECTION FIXING N/90	N.	2,000
415 415001	SPARK PLUG FOR BIG BURNER P6-9	N.	4,000
415 415006	SPARK PLUG FOR BURNER SING	N.	1,000
421 411044	RUBBER FOR PIPE	N.	1,000
433 401155	TIMER KNOB	N.	1,000
433 401193	GAS VALVE KNOB	N.	5,000
433 401330	GAS THERMOSTAT KNOB BRONZE	N.	1,000
441 404042	SIDE GRID F6	N.	2,000
453 411025	GASKET FOR OVEN GLASS FIXING RING F6-M6	N.	8,000
458 409028	TIMER	N.	1,000
464 411027	GASKET FOR GAS VALVE AND SAFETY THERM.M6N.	N.	6,000
475 405037	TOP COVER HINGE LEFT M9/D2	N.	1,000
476 405038	TOP COVER HINGE RIGHT M9/D2	N.	1,000
483 411029	GASKET FOR TOP COVER HINGE M6-P6-P9	N.	2,000
510 505002	GAS HOSE NATURAL GAS P090	N.	1,000
518 507015	FLAME SPREADER BUILT-IN HOB	N.	1,000
520 504041	OVEN BURNER N/90 IND	N.	1,000
539 505005	LARGE BURNER SUPPORT	N.	2,000
540 505006	MEDIUM BURNER SUPPORT	N.	2,000
541 505007	SMALL BURNER SUPPORT	N.	1,000
543 505012	SUPPORT OF OVEN BURNER NOZZLE	N.	1,000
545 505004	GAS HOSE CONNECTION METAL REDUCER	N.	1,000
546 505013	SUPPORT FOR GRILL BURNER NOZZLE	N.	1,000
557 415009	SPARK PLUG	N.	2,000
565 506004	NOZZLE 75	N.	1,000

ARTICOLO				CONSUMO
N° DISEGNO	COMPONENTE	DESCRIZIONE ARTICOLI	UM	UNIT.
*****	*****	*****	*****	*****
565	506006	NOZZLE G20 DIAM 1.30 NATURAL GAS	N.	1,000
565	506010	NOZZLE 0.50 LPG	N.	1,000
565	506013	NOZZLE 0.85 LPG	N.	1,000
565	506016	NOZZLE 0.70 LPG	N.	2,000
565	506017	NOZZLE 1.50	N.	2,000
565	506017	NOZZLE 1.50	N.	1,000
565	506019	OVEN NOZZLE 0.90 LPG	N.	1,000
565	506034	NOZZLE G20 GAS GRILL 1.45	N.	1,000
565	506041	NOZZLE G20 DIAM 150 FAST BURNER	N.	1,000
565	506061	NOZZLE DIAM 170	N.	1,000
565	506066	NOZZLE DIAM 96	N.	1,000
582	505010	RING FOR SUPPORT	N.	5,000
583	508001	THERMOCOUPLES MM 320	N.	1,000
583	508002	THERMOCOUPLE MM 450	N.	2,000
583	508004	THERMOCOUPLE FOR SAFETY OVEN MM 1200	N.	2,000
583	508005	THERM. MM850 2 WAYS SAFETY THERMOSTAT	N.	2,000
622	603002	REDUCTION MOTOR	N.	1,000
623	608018	OVEN BULB WITH HOLDER	N.	1,000
650	601083	GROUND CORD 6000	N.	1,000
722	304003	SEICER FOR SPARK PLUG -BENZING- M/6000	N.	2,000
868	301004	SCREW 5MA X 8 T 1/2 T	N.	11,000
890	502076	SAFETY GAS VALVE 034	N.	1,000
891	502077	SAFETY GAS VALVE 036	N.	2,000
892	502087	GAS VALVE BPO52	N.	1,000
893	502079	GAS VALVE BPO65	N.	1,000
900	101114	OVEN SIDE PANEL M9/D2	N.	2,000
901	101115	OVEN TOP PANEL BLACK M9/D2	N.	1,000
902	101116	OVEN BOTTOM PANEL BLACK M9/D2	N.	1,000
903	101118	FRONT PANEL BLACK M9/D2	N.	1,000
904	101119	OVEN BACK PANEL BLACK M9/D2	N.	1,000
905	101120	OVEN TRAY BLACK M9/D2	N.	1,000
906	101121	OVEN INSIDE DOOR BLACK M9/D2	N.	1,000
908	108084	BLACK DRAWER	N.	1,000
912	20009401	WORK TABLE STAINLESS STEEL	N.	1,000
917	200083	SHORT SIDE INOX M9/D2	N.	2,000
918	200096	DISH WARMER DOOR INOX M9/D2	N.	1,000
919	200081	OVEN GLASS SUPPORT M9/D2	N.	1,000
924	210050	CONTROL PANEL ST.STEEL	N.	1,000
926	201106	BACK PANEL M9/D2	N.	1,000
927	099019	GAS COLLECTOR SUPPORT	N.	2,000
928	202107	ORIZONTAL PROFILE FOR BODY M9/D2	N.	3,000
929	202108	VERTICAL PROFILE FOR BODY M9/D2	N.	2,000
930	202139	FEET SUPPORT	N.	2,000
931	202110	CONTROL PANEL SUPPORT M9/D2	N.	1,000
932	202111	PROTECTION PANEL FOR OVEN BURNER M9/D2	N.	1,000
933	202128	GAS VALVE SUPPORT	N.	2,000
935	202115	WOK BURNER SUPPORT	N.	1,000
936	099029	DISHWARMER DRAWER GUIDE AND ROLLER	N.	2,000
939	203030	INSIDE DISHWARMER DRAWER	N.	1,000
940	202188	WORK TABLE RIGHT SUPPORT	N.	1,000
941	202189	WORK TABLE LEFT SUPPORT	N.	1,000
942	306020	TOP COVER SPRING M9	N.	1,000
943	308019	BUMPER FOR GRIDS M9/D2	N.	4,000

ARTICOLO N° DISEGNO COMPONENTE	DESCRIZIONE ARTICOLI	UM	CONSUMO UNIT.
*****			
943 308019	BUMPER FOR GRIDS M9/D2	N.	12,000
945 403059	SPIT SUPPORT	N.	1,000
951 403069	OVEN DOOR HANDLE M9/D2	N.	1,000
954 404078	OVEN GRID M9/D2	N.	1,000
961 404089	SIDE PAN SUPPORT	N.	2,000
962 404093	WOK PAN SUPPORT M9-E2	N.	1,000
967 405039	OVEN DOOR HINGE M9/D2	N.	2,000
968 405040	OVEN DOOR HINGE FIX PART M9/D2	N.	2,000
969 406139	INTERNAL OVEN GLASS M9/D2	N.	1,000
970 406143	OVEN GLASS STOPSOL M9/D2	N.	1,000
971 406144	GLASS TOP COVER M9/D2 INOX	N.	1,000
972 202147	SUPPORT FOR WORK TABEL FIXING	N.	2,000
973 410095	BACK PROFILE FOR GLASS TOP COVER M9/D2	N.	1,000
974 410122	FRONT PROFILE M9D2	N.	1,000
975 411049	OVEN GASKET M9/D2	N.	1,000
976 501202	GAS COLLECTOR 5 BURNERS GAS OVEN	N.	1,000
978 501221	LEFT BACK TUBE	N.	1,000
979 501222	LEFT FRONT TUBE	N.	1,000
980 501223	RIGHT BACK TUBE	N.	1,000
981 501224	RIGHT FRONT TUBE	N.	1,000
982 501225	WOK BURNER TUBE SAFETY	N.	1,000
988 50122601	OVEN THERMOSTAT TUBE	N.	1,000
990 501228	GRILL THERMOSTAT TUBE	N.	1,000
1001 504082	GRILL BURNER M9/D2	N.	1,000
1002 504083	GAS OVEN BURNER M9-D2	N.	1,000
1003 504093	VENTURI CONE FOR WOK BURNER	N.	1,000
1007 401195	BLACK PUSHBUTTON M9-D2	N.	2,000
1007 401196	RED BUTTON M9/D2	N.	1,000
1008 302050	NUT FOR GAS VALVE	N.	2,000
1010 416006	SPIT WITH CARVING FORKS	N.	1,000
1023 414011	DRAWER ROLLER	N.	2,000
1111 099013	VENT STACK	N.	1,000
1112 402069	FIBRE GLASS FOR OVEN M9/D2	N.	1,000
1113 60401945	UNIPOLAR SWITCH M9/D2	N.	2,000
1114 604020	PUSHBUTTON FOR IGNITION M9/D2	N.	1,000
1130 309047	GRILL BURNER SUPPORT	N.	1,000
1420 411059	GASKET DIAM 16 FOR OVEN DOOR HANDLE	N.	4,000
1606 402084	INSULATING FOR MOTOVENTILATOR AND TURNS.	N.	1,000
1607 401236	SWITCH SUPPORT BLACK	N.	3,000
4132 401007	SPIT HANDLE	N.	1,000
4280 401156	GAS VALVE KNOB RING	N.	5,000
4280 401158	GAS THERMOSTAT KNOB RING	N.	1,000
4280 401162	TIMER KNOB RING	N.	1,000
4301 410080	VERTICAL PROFILE RIGHT	N.	1,000
4302 410081	VERTICAL PROFILE LEFT	N.	1,000
4305 414009	FEET M9/D2	N.	4,000
4306 415035	ACCOMULATOR M9D2	N.	1,000
5162 507016	PAN FOR SPREADER	N.	1,000
5163 507017	PART FOR SPREADER	N.	2,000
5164 507018	PART FOR SPREADER	N.	1,000
5165 504070	SMALL BURNER	N.	1,000
5166 504071	MEDIUM BURNER	N.	2,000
5167 504072	BIG BURNER	N.	1,000